

DO NOT SCALE  
Remove All Sharp Edges

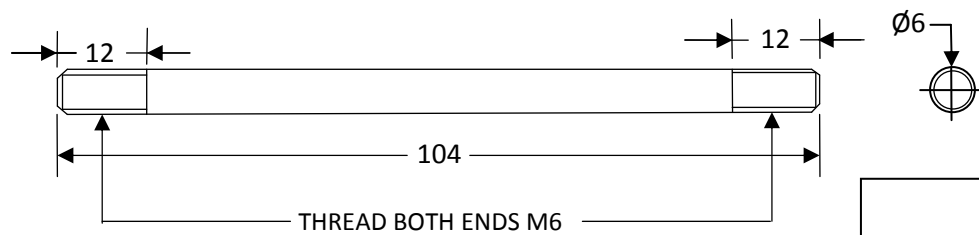

Drawn by	Part <i>HAMMER</i>
	Material <i>B.D.M.S</i>
Dimensions	mm unless otherwise stated

DO NOT SCALE

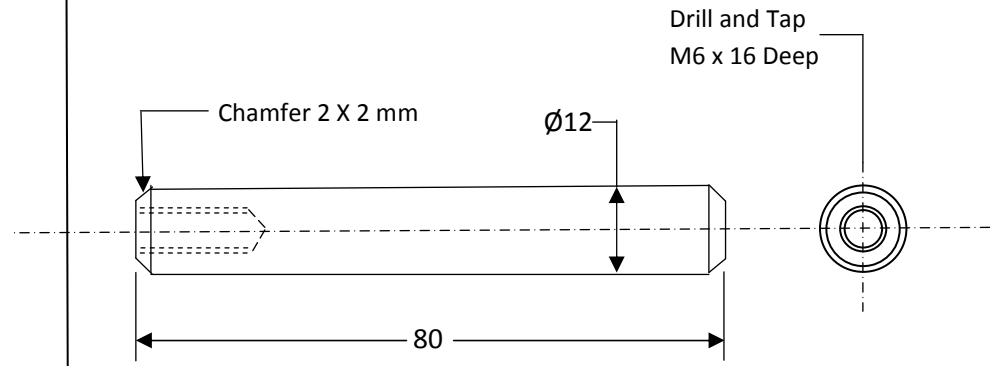
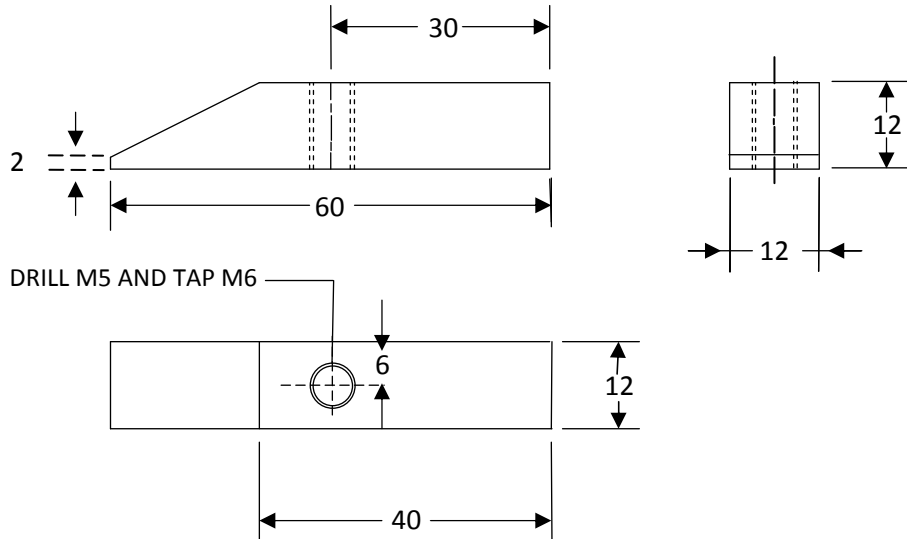
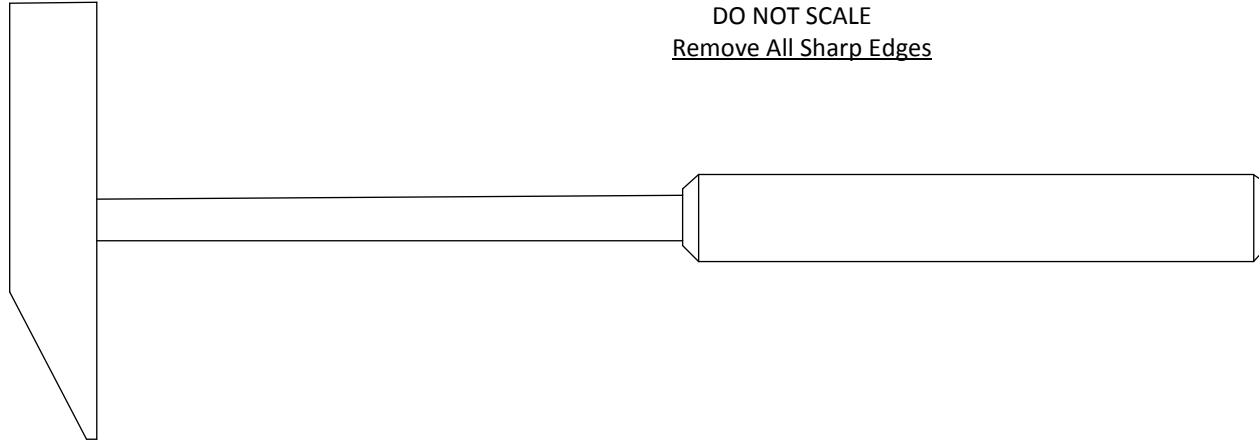
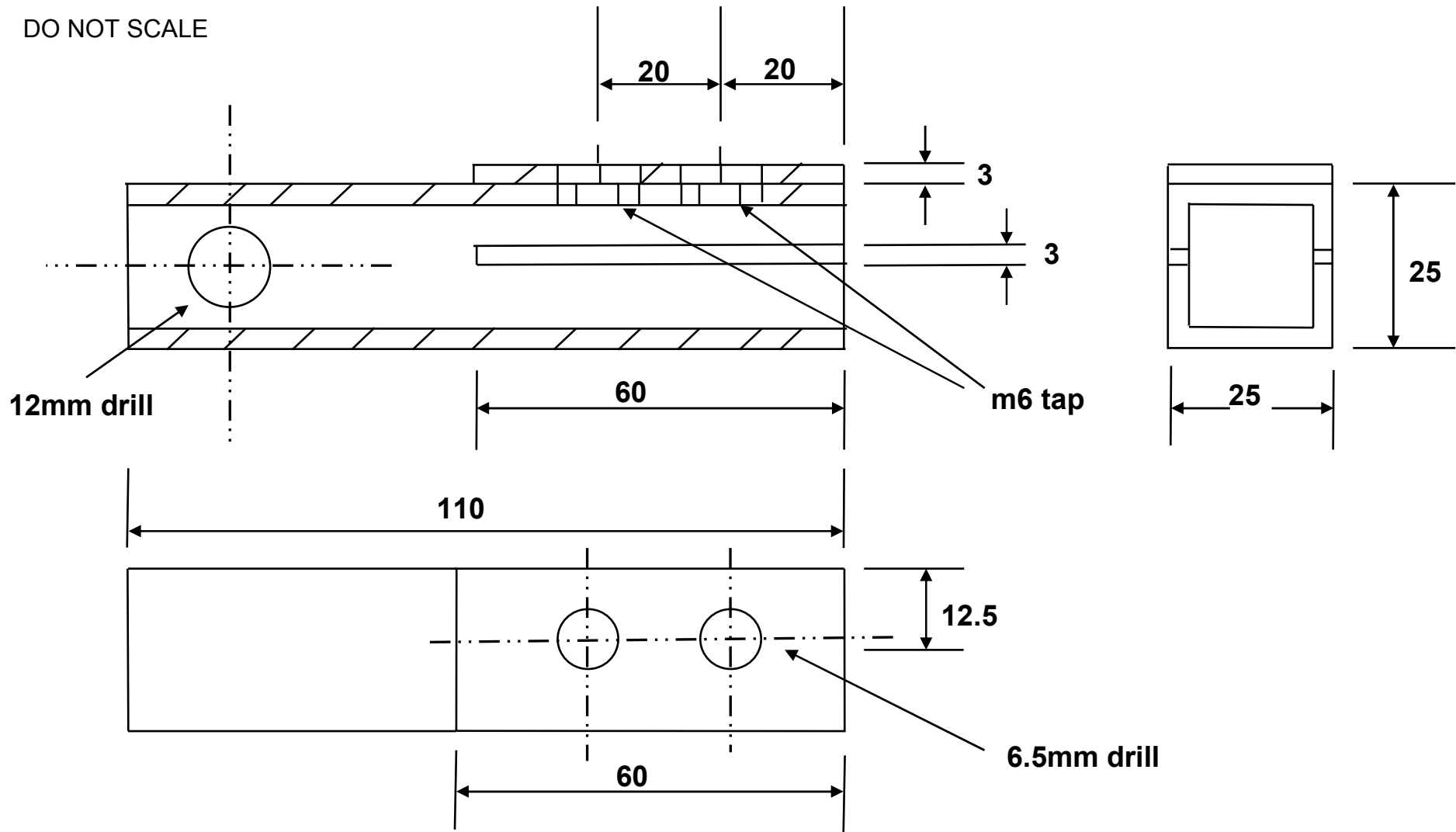

Materials	Units	Title		Drawing No.
L.C.S 25mm box section	mm	Oil Filter Strap		1

DO NOT SCALE

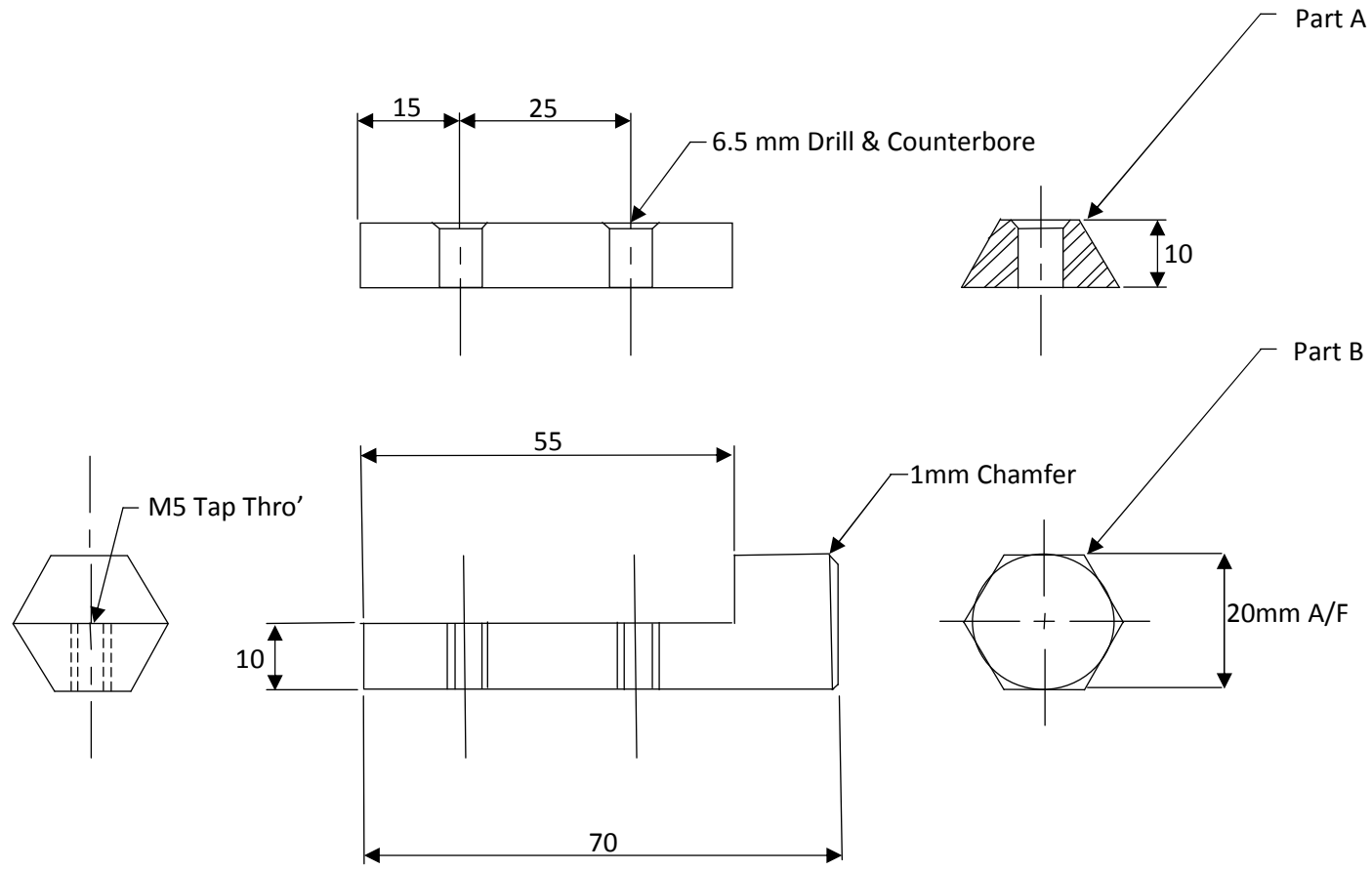
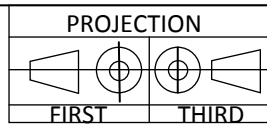

A	Clamp	1
B	Body	1
NO	DESC	QTY
PARTS LIST		

DRAWN BY	CHECKED BY	TOLS – UNLESS STATED	MATERIALS	DIM UNITS	TITLE	DRAWING NO
		± 1	L.C.S	mm	Oil Filter Strap	
DATE:	DATE:					ISSUE:

∅ 6.5 x2 c/sk @ ∅ 8

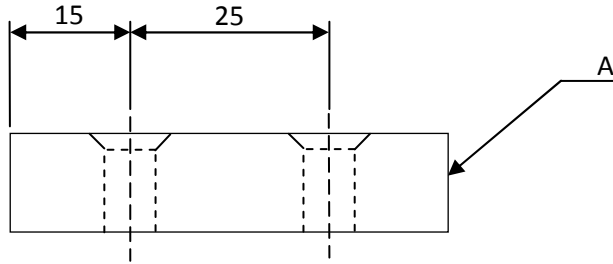
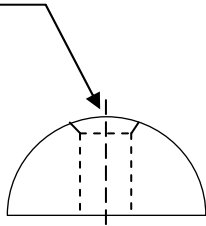

Part A is obtained by sawing out the centre line of part B and across at 55mm length. Drill through @ ∅5 before cutting.

∅ 25

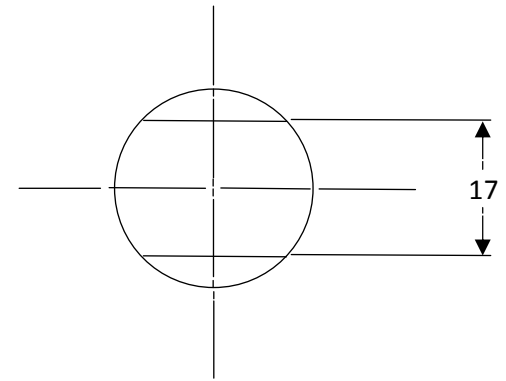
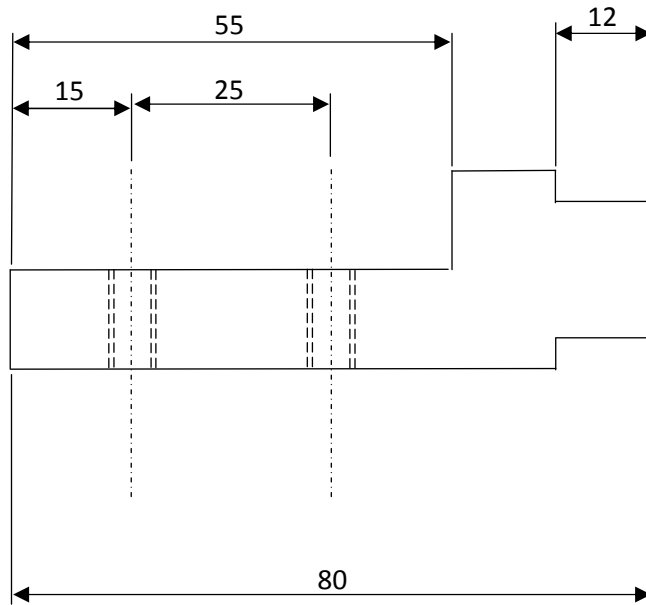
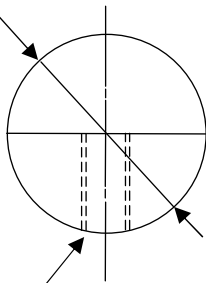

M6 x 1.0p x2

**DO NOT SCALE**

ISSUE	DETAIL	SIGN	TOLERANCES		MATL & FINISH	
			FRACTIONAL DIMS	+/- 0.5		B.D.M.S Polished
			DECIMAL DIMS	+/- 0.25		
			UNLESS OTHERWISE STATED			
			DIMENSIONS IN mm			
			TITLE			
			OIL FILTER STRAP WRENCH			